

PRINCIPALS NEWSLETTER

March 23, 2021

This coming Monday, March 29th, we begin Trimester 3 (cycle 21), and we return to our regular academic six-period, block-rotating schedule. Students should be cognizant that the start time for Academics, including check-in's for shop, will return to 7:40 a.m. and attendance will be taken at that time. The Academic Support Program will end on March 25th. Effective March 29th, teachers will be available by appointment for support from 2:31 p.m.- 3:00 p.m. Monday through Thursday.



ACADEMIC SIX-PERIOD SCHEDULE

**EFFECTIVE THIS MONDAY,
MARCH 29, 2021**

ALL ATTENDANCE WILL BE TAKEN AT 7:40 A.M.

Period	Day 1	Day 2	Day 3	Day 4	Day 5	Day 6
A 7:40am - 8:36am	BLOCK 1	BLOCK 2	BLOCK 3	BLOCK 4	BLOCK 5	BLOCK 6
B 8:44am - 9:40am	BLOCK 2	BLOCK 3	BLOCK 4	BLOCK 5	BLOCK 6	BLOCK 1
C 9:48am - 10:44am	BLOCK 3	BLOCK 4	BLOCK 5	BLOCK 6	BLOCK 1	BLOCK 2
D 10:52am - 11:48am	BLOCK 4	BLOCK 5	BLOCK 6	BLOCK 1	BLOCK 2	BLOCK 3
E 11:52am-12:23pm	LUNCH	LUNCH	LUNCH	LUNCH	LUNCH	LUNCH
F 12:26pm - 1:22pm	BLOCK 5	BLOCK 6	BLOCK 1	BLOCK 2	BLOCK 3	BLOCK 4
G 1:30pm - 2:31pm	BLOCK 6	BLOCK 1	BLOCK 2	BLOCK 3	BLOCK 4	BLOCK 5

Parent/Guardian Morning Drop-Off

Parents/Guardians are kindly reminded that both lanes for morning drop-off are open to all. For safety reasons, we urge families that if you are coming from the North side (from Trucchi's), please use the north lane entrance and stay in your lane as you proceed around the horseshoe. If you are coming from the South side (from Tarklin Hill Road), please use the south lane entrance and stay in your lane as you proceed around the horseshoe. Please see map below.

CHROMEBOOK DISTRIBUTION

The last division of seniors will be distributed their Chromebooks this Thursday, March 25th whilst in shop. Seniors should ensure any school-issued Chromebooks and chargers are returned on this day. Coop and Edgenuity students are not required to complete the Chromebook distribution at this time.

All students are reminded that they must be using a GNBVT-approved virtual background or blurred tool when participating in any online/remote learning.

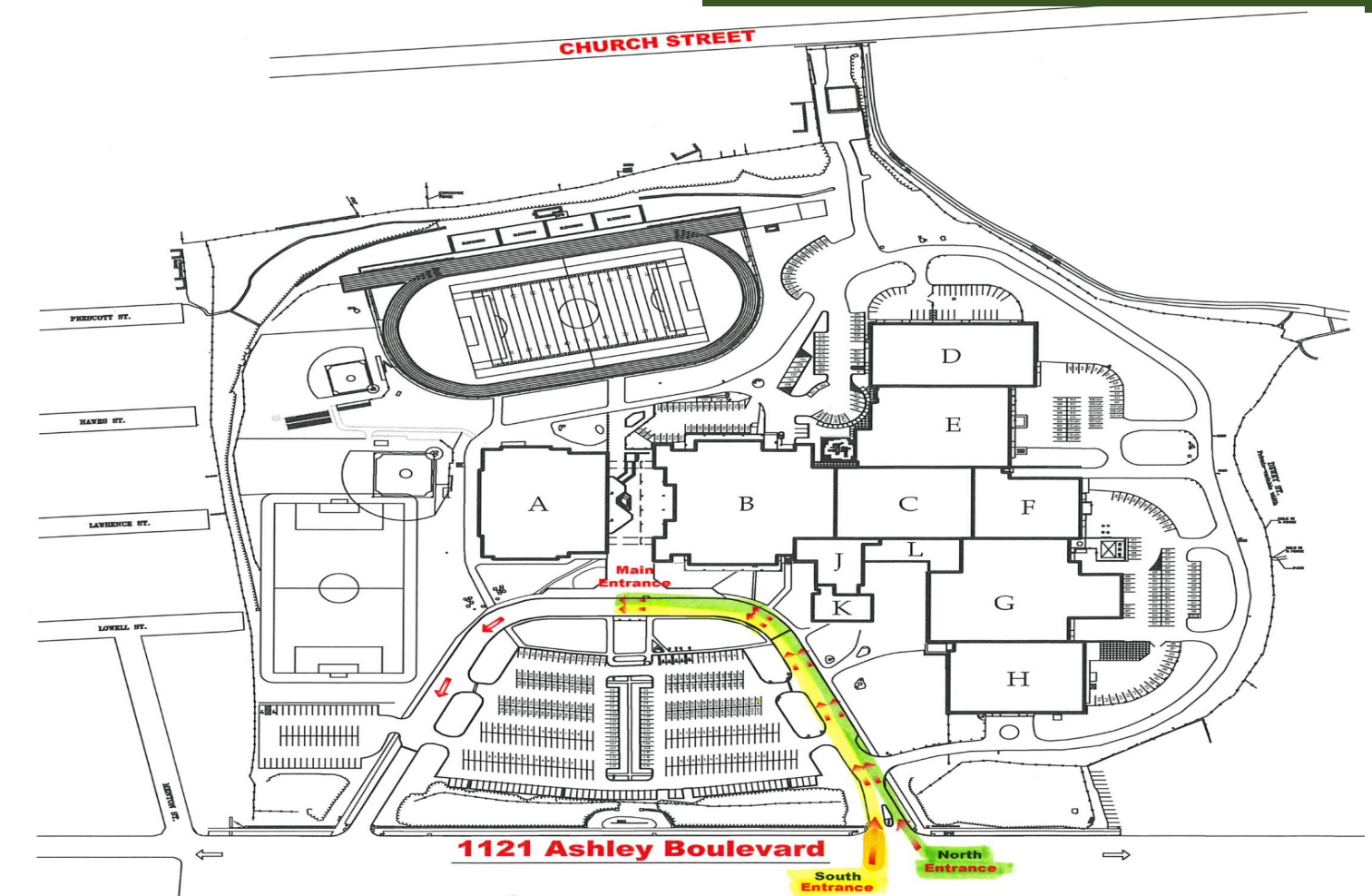

ACADEMIC SIX-PERIOD SCHEDULE

EFFECTIVE TRIMESTER 3 - MARCH 29, 2021

ALL ATTENDANCE WILL BE TAKEN AT 7:40 A.M.

Period	Day 1	Day 2	Day 3	Day 4	Day 5	Day 6
A 7:40am - 8:36am	BLOCK 1	BLOCK 2	BLOCK 3	BLOCK 4	BLOCK 5	BLOCK 6
B 8:44am - 9:40am	BLOCK 2	BLOCK 3	BLOCK 4	BLOCK 5	BLOCK 6	BLOCK 1
C 9:48am - 10:44am	BLOCK 3	BLOCK 4	BLOCK 5	BLOCK 6	BLOCK 1	BLOCK 2
D 10:52am - 11:48am	BLOCK 4	BLOCK 5	BLOCK 6	BLOCK 1	BLOCK 2	BLOCK 3
E 11:52am-12:23pm	LUNCH	LUNCH	LUNCH	LUNCH	LUNCH	LUNCH
F 12:26pm - 1:22pm	BLOCK 5	BLOCK 6	BLOCK 1	BLOCK 2	BLOCK 3	BLOCK 4
G 1:30pm - 2:31pm	BLOCK 6	BLOCK 1	BLOCK 2	BLOCK 3	BLOCK 4	BLOCK 5



Academic Support Program Homework/Tutoring Sessions

February 23-March 25

When: Tuesdays & Thursdays

Time: 3:30 pm - 4:30 pm

Where: Virtual Google Meet Sessions

How do I join?

Step 1: Open a google meet session

**Step 2: Use the session title as the
"google nickname"**



Step 3: Click continue and then join.

***Must use gnbvt.edu email log-in**

**Still need help? Click this link to
watch a video on how to join.**



Academic Support Algebra 1

Academic Support Math

Academic Support Biology

Academic Support ELA

Academic Support ELL

**Academic Support
Special Services History**

[How to join video!](#)

Email Sarah Blanchette- Academic
Support Coordinator with any questions.
sarah.blanchette@gnbvt.edu